



BOURBON TRIESTE- MPSV

DP2 Multi-Functional support vessel
3,210 t deadweight



BOURBON TRIESTE is a De Hoop design, diesel electric, DP2, multi-purpose subsea services support vessel with twin deep water crane.

The vessel is designed for world-wide, deep water operations to fulfill the following duties.

- Subsea installation work and Deepwater precision lifting.
- ROV Operations.
- Survey.
- Maintenance of floating hoses.
- Maintenance of SPMs bouys.
- Fire-fighting.
- Oil recovery operations.
- Stand by rescue.

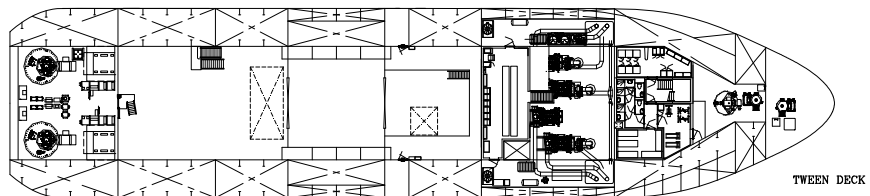
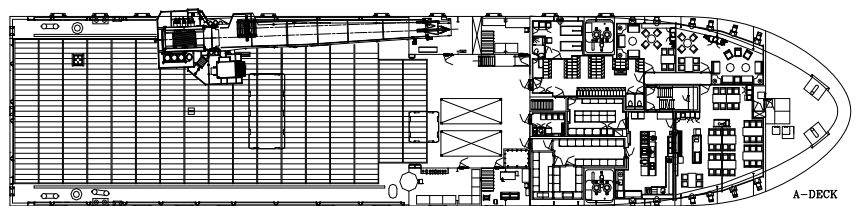
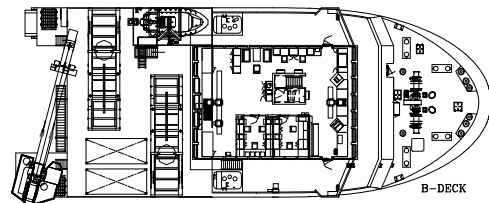

MULTI PURPOSE SUPPLY VESSEL

REGISTRATION

Vessel Name: **BOURBON TRIESTE**

Builder: **De Hoop Shipyard-Netherlands - 2007.**

Class: **BV HULL, MACH, Unrestricted Navigation, AUT - UMS, DYNAPOS AM/AT R, SDS, ALM, Oil recovery ship, Fire Fighting Ship 1, Standby Rescue Vessel, 150 persons in tropical area**

Owner: **Bourbon Offshore**

Flag: **Luxembourg**

Updated: 03-03-2009



MAIN PARTICULARS

DIMENSIONS

Length overall:84.69 m
 Breadth moulded:18.00 m
 Depth:7.40 m
 Draft:5.75 m
 Deadweight:3,210 t
 Bollard pull: (for info).....50 t

CAPACITIES

Clear deck area: (10 t/m² & 5 t/m²)800 m²
 Sheltered deck area: (5 t/m²)130 m²
 Mezzanine deck area:260 m²
 Deck cargo:1,245 t
 Fuel oil:770 m³
 Oil recovery:300 m³
 Fresh water:370 m³
 Ballast water:1,640m³

ACCOMMODATIONS

Accommodations for:70 pers
 Single cabins:10
 2 man cabins:24
 3 man cabins:4
 Office:4
 Hospital:1
 Mess / Day rooms:2
 Laundry:1
 Galley:1

Moonpool: (not open).....7.40 x 7.40 m
 Below deck workshop:34.0 x 10.0 m
 Hatch harbour:6.50 x 2.80 m at sea 1.80 x 1.80 m
 Active anti heeling:2 x 1,300 m³/hr

MACHINERY / PERFORMANCE

PROPULSION - MACHINERY

Main engines:4 x 1,700 kVA
 Propellers FP:2 x 1,800 kW
 Bow thrusters FP:2 x 780 kW Tunnel
 Azimuth thruster forward:600 kW
 Air compressor:1,200 m³/h @ 7 bars
 Emergency generator:300 kW
 Deck ROV power supply:2 x 500 kW

SPEED / CONSUMPTION

Maximum speed (100%):13 knots
 Economic speed (50%):10 knots

EQUIPMENT & ELECTRONICS

DECK EQUIPMENT

Main deck crane AHC NATOIL:
 Main winch – AHC 1,600 m wire dia 62 mm.
 - 110 t (double fall) harbour DAF 1.2 @ 12 m.
 - 100 t (double fall) offshore DAF 1.6 @ 12 m.
 - 90 t (Single fall) Offshore DAF 1.6 crane @ 13 m.
 - 30 t @ 30 m radius.
 2nd winch: AHC -10 t –2,000 m wire dia 30 mm, man riding.
 2nd deck offshore crane: 2300 m wire-30 mm diameter.
 - 24 t @ 10 m – 8 t @ 19 m (harbour double fall).
 - 12 t at 10 m – 6 t @ 19 m (single fall) offshore.
 - Man riding.
 Capstans:2 x 5 mt.

SAFETY EQUIPMENT

Fire Fighting (Fifi 1).
 - Pumps : 2 pumps 2,400 m³/h.
 - Monitors : 2 monitors 1,200 m³/h.
 Fast rescue Seabar 23 MKII.
 Morgue for 15 corpses.
 150 person rescue equipment as per SOLAS/BV.

ELECTRONICS

DYNAMIC POSITIONING (BV class DYNPOS AUTR-DP2)

Converteam.
 2-DGPS Aquarius Thales type 1 & 2.
 1 USBL Sonardyne – head 8023.
 Laser (cyscan).
 MRU type DMS05 & RP25.
 2 wind sensors.
 3 Meridian TSS gyro.

NAVIGATION

1 radar S-band -1 radar X-band –1 radar slave.

COMMUNICATION

UHF, VHF, Sat C, Fleet 77.
 KU band 128 kbit.
 Cat 5 network, Video network, Telephone/video in all cabin.

All particulars believed to be correct but not guaranteed